

ASSEMBLY INSTRUCTIONS

- Please read carefully before start the assembly.
- A minimum 4 people required for assembly due to the legs needing to be aligned exactly with the top. Three people to hold the top, while the forth positions the legs accordingly. Also probably need to mention that utmost care is needed when placing the top onto the legs so that chipping doesn't occur.
- To prevent damage to your floor or carpet, please check the bottom of each piece of furniture for stain residue and rough surfaces and check for staples or nails left after removing the packaging material.
The manufacturer will not be held responsible if preventative steps are not taken prior to installation.
- Unpack and dispose of all packing material but be careful not to throw away any assembly parts or hardware.
Read the instruction sheet and parts list carefully. Remove all staples and screws used for packaging carefully using pliers and (or) screwdrivers to prevent injury and scratching or damaging flooring.

PARTS INCLUDED:

A. BASE WITH HARDWARE PLATE [x3]

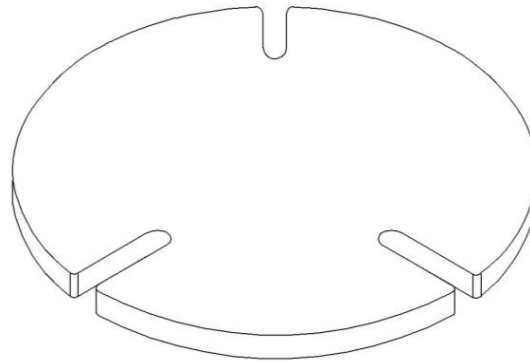

B. TABLETOP [x1]

**HARDWARE :**

C. ALLEN KEY BOLT M6 [x12 + 2 Extra]



D. ALLEN KEY M6 [x1]

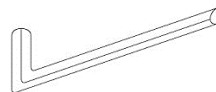

STEP 1 :

Open the TABLETOP (B) carefully as it is heavy and place it in its final location keeping the bottom part sky facing, make sure the surface is neat to avoid scratches on the top part. Use carpet or soft cloth before laying down the top for assembly.

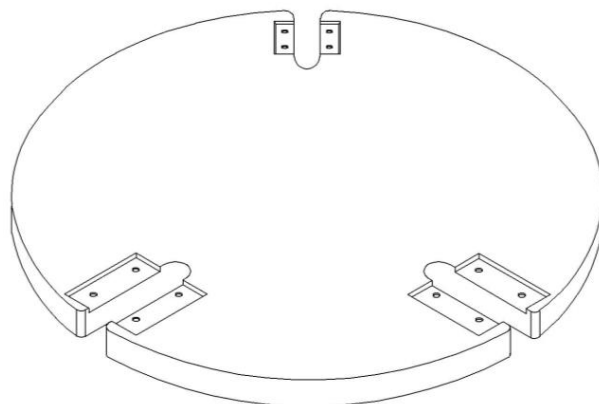

IMAGE 1-UPSIDE DOWN TOP

STEP 2 :

Unpack all legs. There are stickers placed underneath of stone top cavity (IMAGE-2) and bottom side of metal plate of legs (IMAGE-3) for easy assembly, shown in the image. All place are marked with A/B/C stickers. Put leg on the top with matching the sticker (IMAGE-4). Lock it using the M6 bolt and M6 Alloy key, attached in the hardware kit. Ensure all bolts are completely tightened.

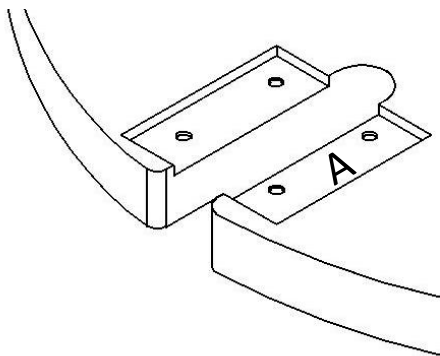

IMAGE 2-TOP STICKER

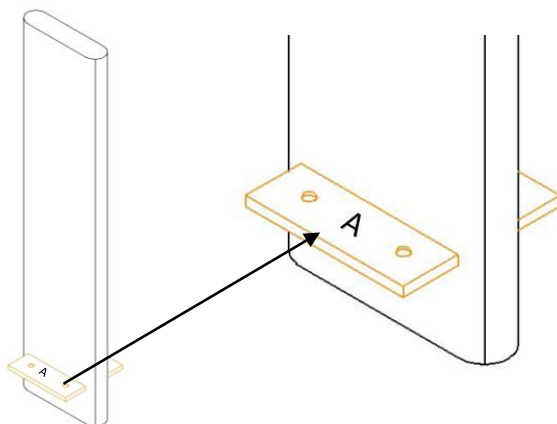

IMAGE 3-BASE STICKER

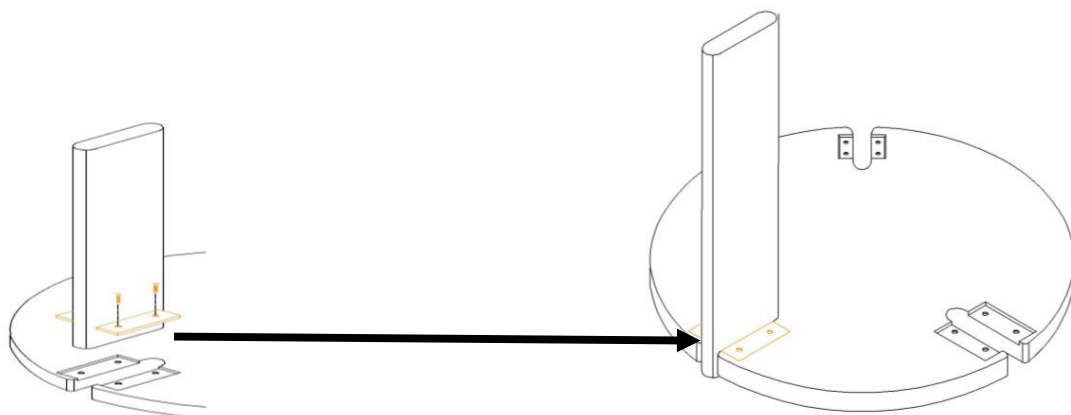

IMAGE 4-ASSEMBLY OF BASE WITH TOP

STEP 3 :

Repeat the same process for all three legs with matching the stickers.

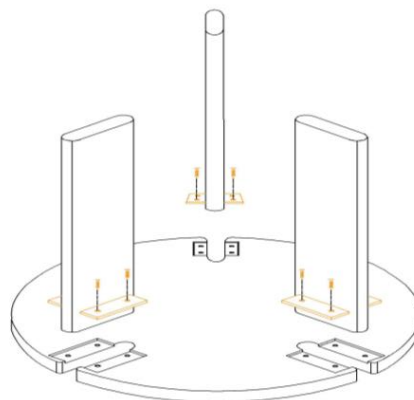

IMAGE 5 - ALL 3 BASE ASSEMBLY WITH TOP

STEP 4 :

Before moving the table in the correct position check all the hardware fitting, and slowly flip the table in air, **do not flip the table keeping it on one leg for support, it might break the leg, as the table weight will be transferred on one leg.** For moving the product 3 persons are recommended. Your table is ready to use.

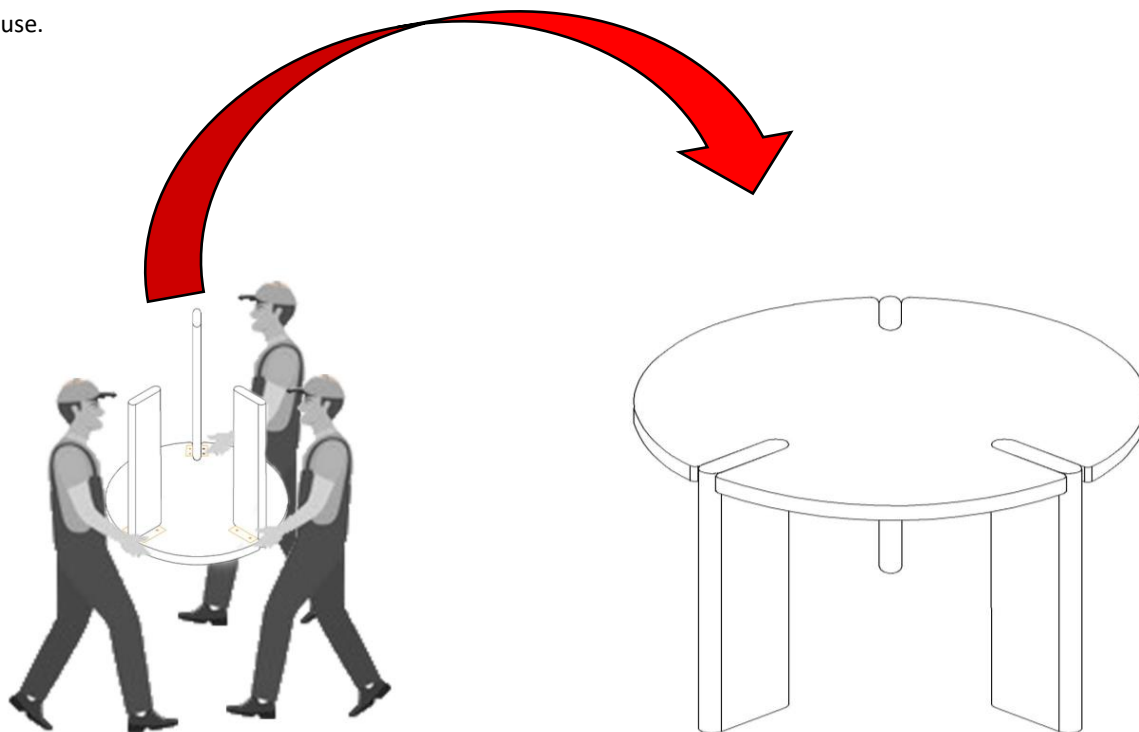

IMAGE 6 - MOVING THE TOP IN AIR, TO KEEPING IT IN CORRECT POSITION

CARE & MAINTANCE INSTRUCTIONS

- Use a clean soft cotton cloth to wipe the surface. Do not use abrasive or chemical cleaners.
- Wipe the surface immediately if any liquid product spills on the top.
- During normal use every day, screws, bolts, nuts, and wooden plugs may loosen up. They should be periodically inspected and re-tightened to prevent damage to the furniture and (or) personal property or cause injury. Always check to be sure all hardware on this list and the above-mentioned components is attached to the furniture properly and kept always tightened.
- In case of relocation, dismantle the product first and follow the assembly instructions for re-assembly.